



MEETINGS AND EVENTS

W

CHICAGO
LAKESHORE



ALTITUDE



GREAT ROOM

MEETING AND EVENT FLOOR PLANS

FIRST FLOOR

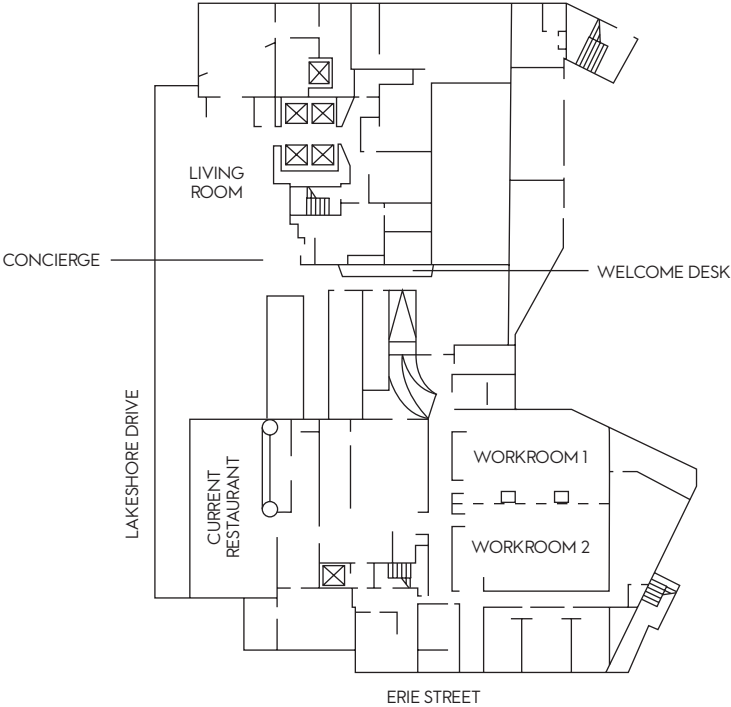

SIXTH FLOOR

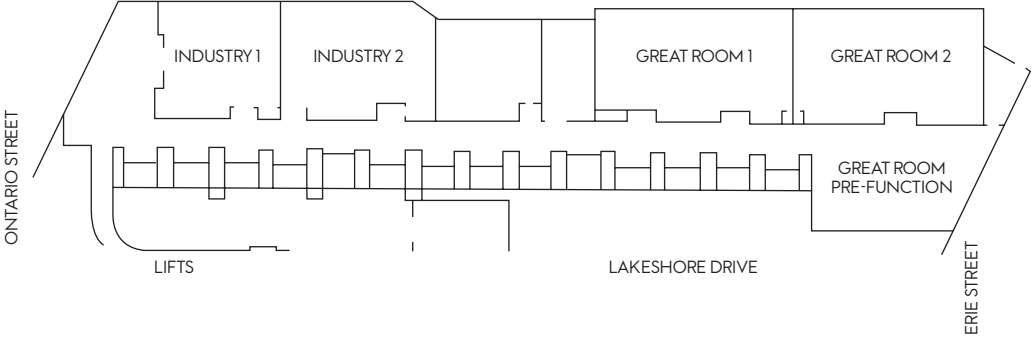

For more information on planning your get-together, contact our dedicated event specialist at 312.255.4429.

MEETING AND EVENT FLOOR PLANS

SEVENTH FLOOR

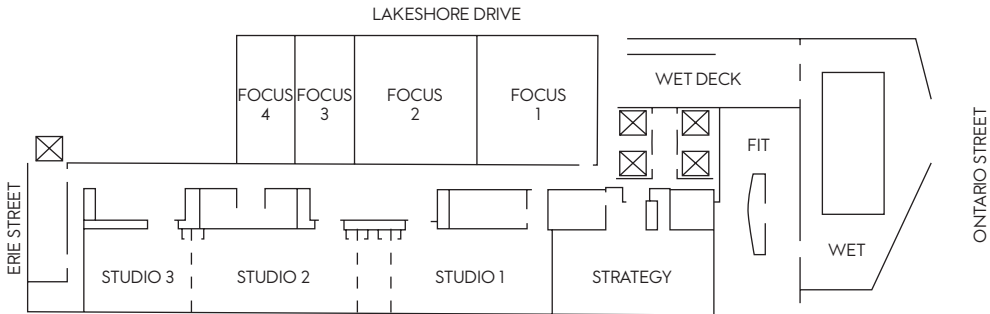

THIRTY-THIRD FLOOR

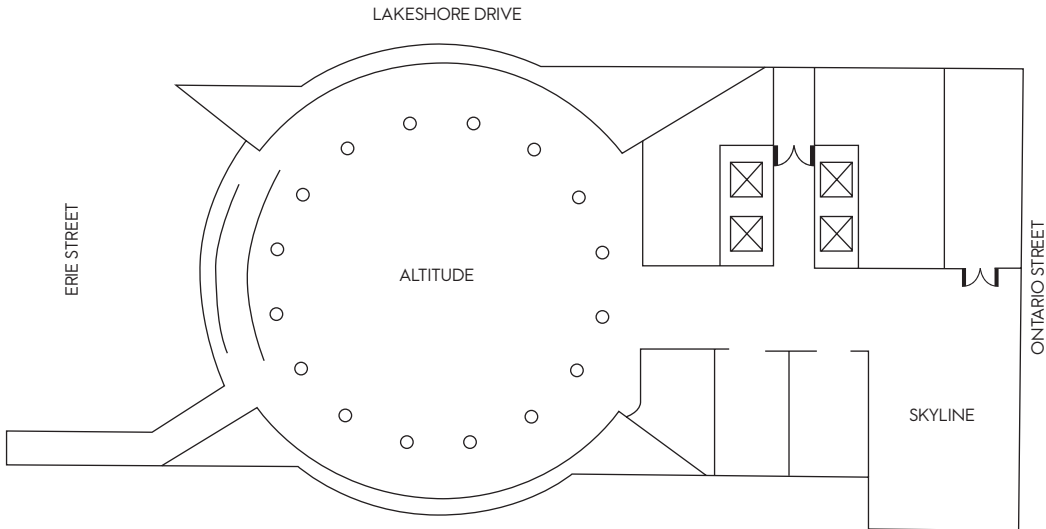

For more information on planning your get-together, contact our dedicated event specialist at 312.255.4429.

Room Name	Dim. (l x w)	Area	Height	Banq.	Thtr.	Conf.	Rec.	Class	U-Shp.
First Floor									
Workroom 1	25.0' x 40.0'	1,175ft ²	8.0'	70	100	36	100	60	36
Workroom 2	25.0' x 47.0'	1,175ft ²	8.0'	70	100	38	100	60	36
Workroom 1 & 2	50.0' x 47.0'	2,350ft ²	8.0'	-	180	38	150	120	38
Sixth Floor									
Industry 1	28.0' x 25.0'	700ft ²	10.0'	50	70	28	50	36	28
Industry 2	28.0' x 25.0'	700ft ²	10.0'	50	70	28	50	36	28
Industry 1 & 2	56.0' x 25.0'	1,400ft ²	10.0'	100	140	35	100	72	35
Prefunction	-	-	10.0'	40	-	-	50	-	-
Great Room 1	50.0' x 25.0'	1,250ft ²	10.0'	100	140	50	130	80	50
Great Room 2	50.0' x 25.0'	1,250ft ²	10.0'	80	125	50	100	60	50
Great Room 1 & 2	100.0' x 25.0'	2,500ft ²	10.0'	216	230	80	250	144	80
Prefunction	-	-	10.0'	60	-	-	70	-	-
Deck	33.0' x 130.0'	4,290ft ²	-	280	-	-	350	-	-
Seventh Floor									
Strategy	18.0' x 36.0'	648ft ²	8.0'	-	-	14	-	-	-
Studio 1	37.0' x 18.0'	666ft ²	8.0'	50	60	30	50	40	30
Studio 2	37.0' x 18.0'	666ft ²	8.0'	50	60	30	50	40	30
Studio 3	24.0' x 18.0'	432ft ²	8.0'	30	40	20	20	30	20
Studio 1 & 2	74.0' x 18.0'	1,332ft ²	8.0'	90	100	-	80	60	35
Studio 2 & 3	81.0' x 18.0'	1,098ft ²	8.0'	80	90	-	70	50	35
Studio 1 & 2 & 3	98.0' x 18.0'	1,764ft ²	8.0'	120	120	-	80	70	40
WET® Deck	19.0' x 49.0'	931ft ²	-	-	-	-	65	-	-
Focus 1	26.7' x 24.5'	655ft ²	8.0'	20	40	18	30	24	21
Focus 2	26.7' x 24.5'	655ft ²	8.0'	12	40	18	30	24	21
Focus 3	11.8' x 26.0'	307ft ²	8.0'	12	15	12	12	12	12
Focus 4	11.8' x 26.0'	307ft ²	8.0'	12	15	12	12	12	12
Thirty-third Floor									
Altitude	70.0' x 70.0'	3,800ft ²	10.0'	240	220	50	300	120	80
Skyline	26.0' x 30.0'	779ft ²	8.4'	50	50	30	50	30	30